

SW / BW

Plug valves with weld ends

DIN-EN: DN 10 - 500 / PN 10 - 100

ASME: NPS 3/8" - 24" / class 150 - 600

PT range: $-30 < T < 230/280^{\circ}\text{C}$, vacuum 10-8 mbar



Design Features

Design Characteristics

- available with butt weld and socket weld ends
- free of cavities
- maintenance free - self lubricating
- mounting-flange for actuators acc. to DIN ISO 5211
- easy accessible adjustment of the plug, even with mounted actuator

- vacuum tight
- fugitive emission resp. clean air act certified (TA - Luft 2002 approval)
- PED 97/23/EG
- fire safe design API 607 / ISO 10497
- FDA conformity

PT-Diagram

General Pressure-Temperature-Diagram

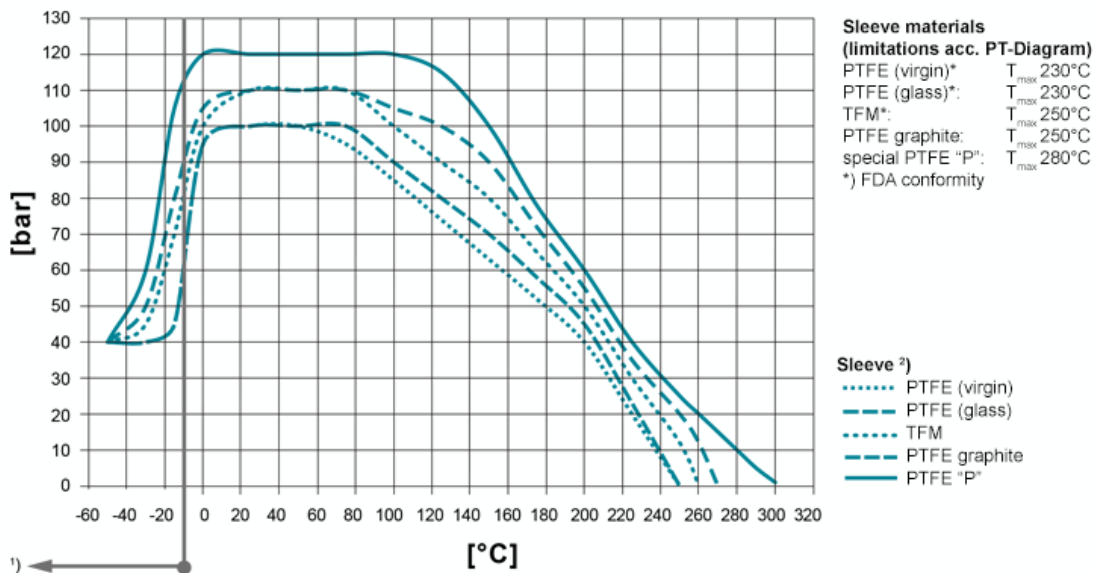

Operating temperatures < -30°C and > 220 °C have to be checked and approved by AZ according to the operating conditions.

Besides the P/T value of the sleeve the limitations of the valve bodies also have to be considered. Please refer to the EN 12516-1 resp. ASME B16.34 in order to choose a proper pressure rating (PN/class). The shown values refer to austenitic stainless steel 1.4408 (A351 Gr. CF8M).

- 1) For operating temperatures below -10°C low temperature / austenitic steels are required.
- 2) Sleeve: There are different sleeve materials / compounds available.

Materials

Standard body materials

- Carbon Steel 1.0619, ASTM A216 WCB
- Stainless Steel 1.4408, ASTM A351 CF8M
- Stainless Steel 1.4308, ASTM A351 CF8
- Unalloyed stainless steel casting (low Temp.) 1.1138, LCC/LCB/A352

Standard plug materials

- Stainless Steel 1.4408, ASTM A351 CF8M

- Stainless Steel 1.4308, ASTM A351 CF8

Special materials

- Alloy
- Monel
- Nickel
- Zirconium
- Titan
- Tantal
- other materials on request

Sealing Systems

Standard sealing for all major applications;
Tmax 230°C

Type STD

Firesafe sealing (API 607) with Graphite packing for additional stem sealing; Tmax 230°C

Type FS

Chemical sealing to prevent fugitive emissions of aggressive and toxic media with PTFE packing for additional stem sealing; T_{max} 230°C

Type CA

Firesafe safety sealing (API 607) for fluctuating temperatures with 3x Graphite packing (adjustable) for additional stem sealing; Tmax 280°C

Type FSN

Firesafe safety sealing (API 607) for fluctuating temperatures with 3x Graphite packing (live loaded disc springs) for additional stem sealing; Tmax 280°C

Type FSN-SL

Chemical safety sealing for fluctuating temperatures with 3x PTFE packing (adjustment) for additional stem sealing; Tmax 230°C

Type CASN

Chemical safety sealing for fluctuation temperatures with 3x PTFE packing (live loaded disc springs) for additional stem sealing; Tmax 230°C

Type CASN-SL

Port Forms



AZ plug valves are fitted with cast, rust proof position indicators
The position indicator is securely welded to the plug to prevent it from working loose.

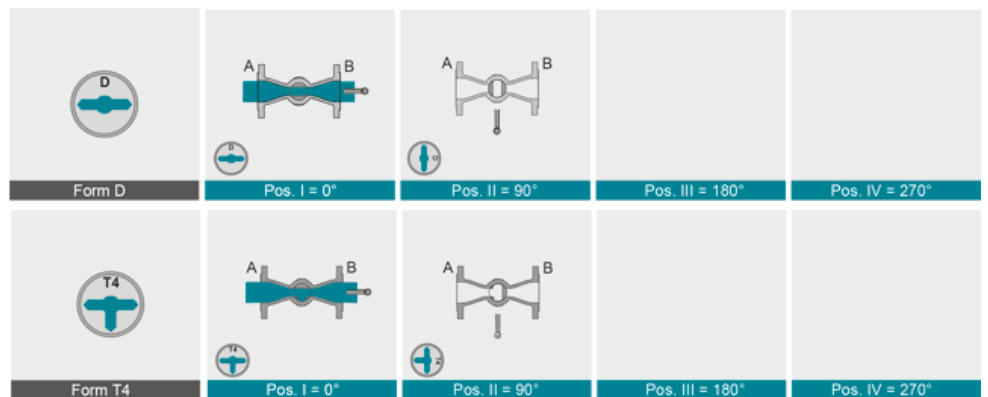
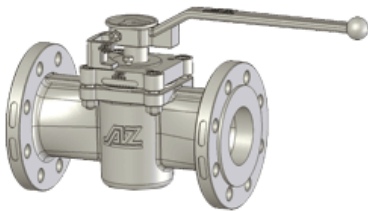
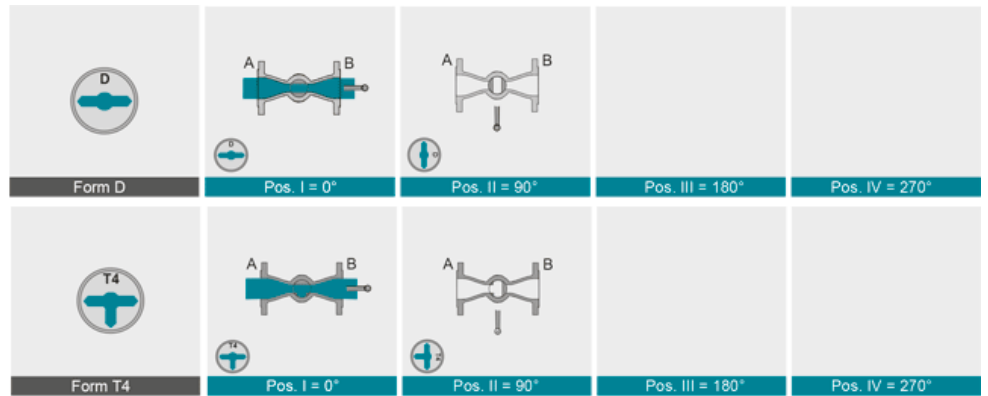
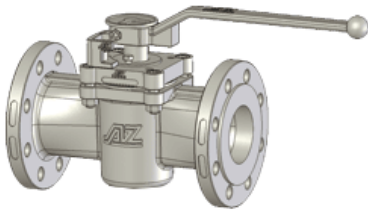

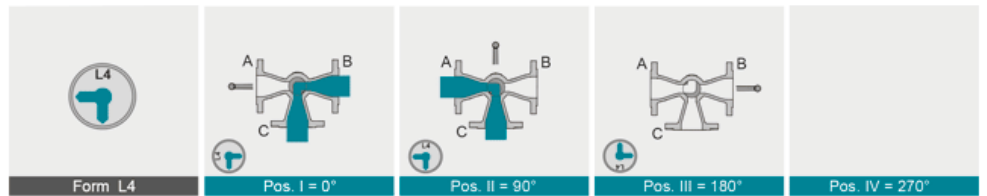
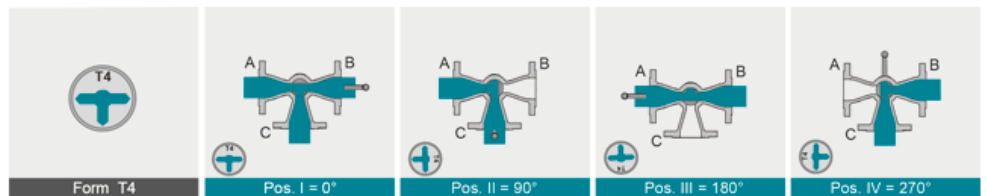
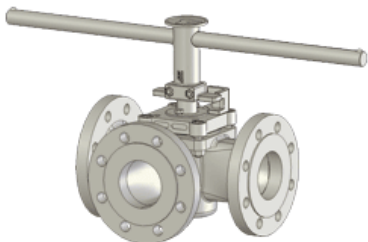
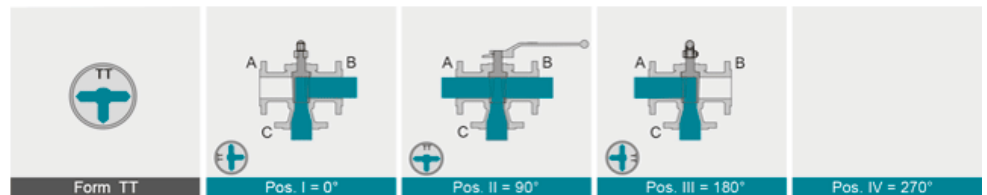
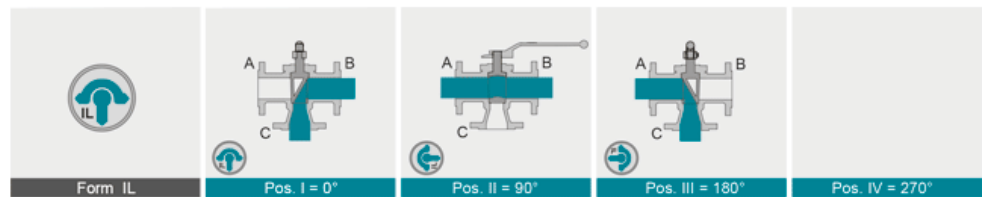
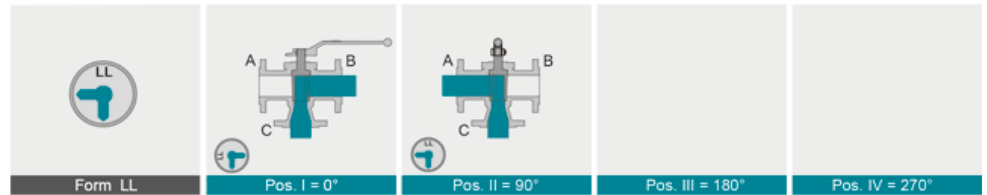
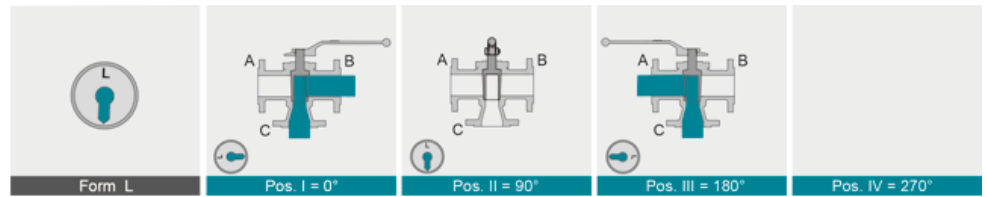
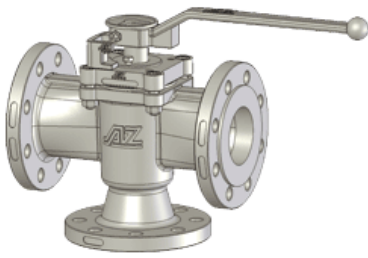

others on request

Technische Daten

Typ BW

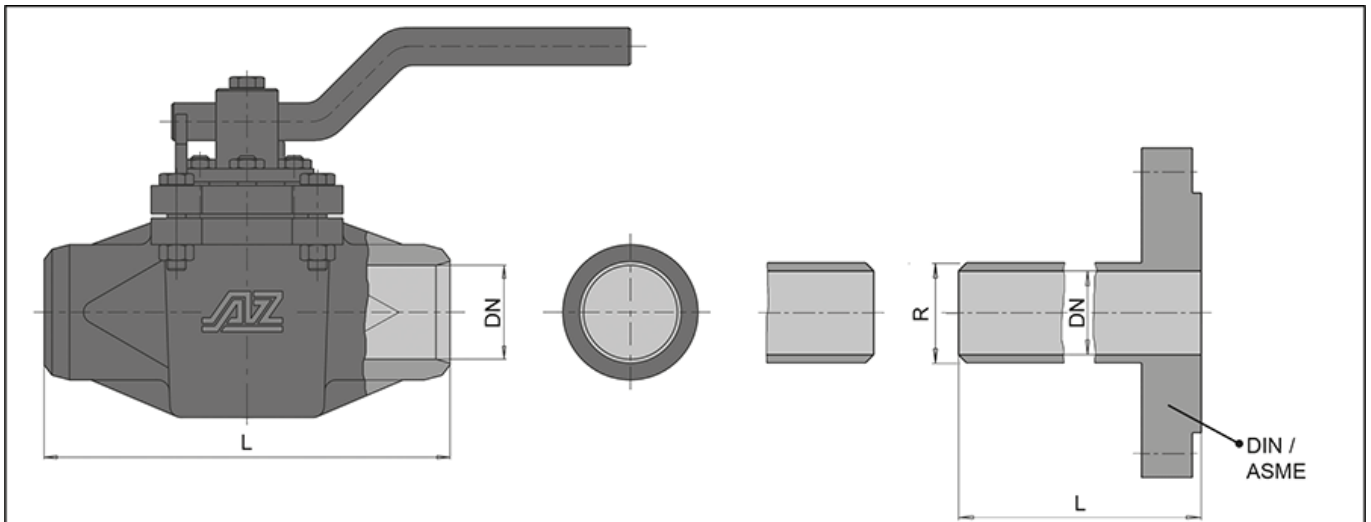

	DN		L*		R*	
	DIN	ANSI	DIN	ANSI	DIN	ANSI
Buttwelding Ends	10	3/8"	165	130	18	18
	15	1/2"	165	140	22	22
	20	3/4"	165	152	28	28
	25	1"	165	165	35	35
	32	1 1/4"	180	178	44	44
	40	1 1/2"	200	190	50	50
	50	2"	230	216	62	62
	65	2 1/2"	290	241	77	77
	80	3"	310	283	91	91
	100	4"	350	305	117	117
	125	5"	325	381	144	144
	150	6"	432	403	172	172
	200	8"	508	419	223	223
	250	10"	450	450	278	278
	300	12"	500	500	329	329
	350	14"	550	550	362	362
400	16"	600	600	413	413	
450	18"	650	650	464	464	
500	20"	700	700	516	516	

Typ SW

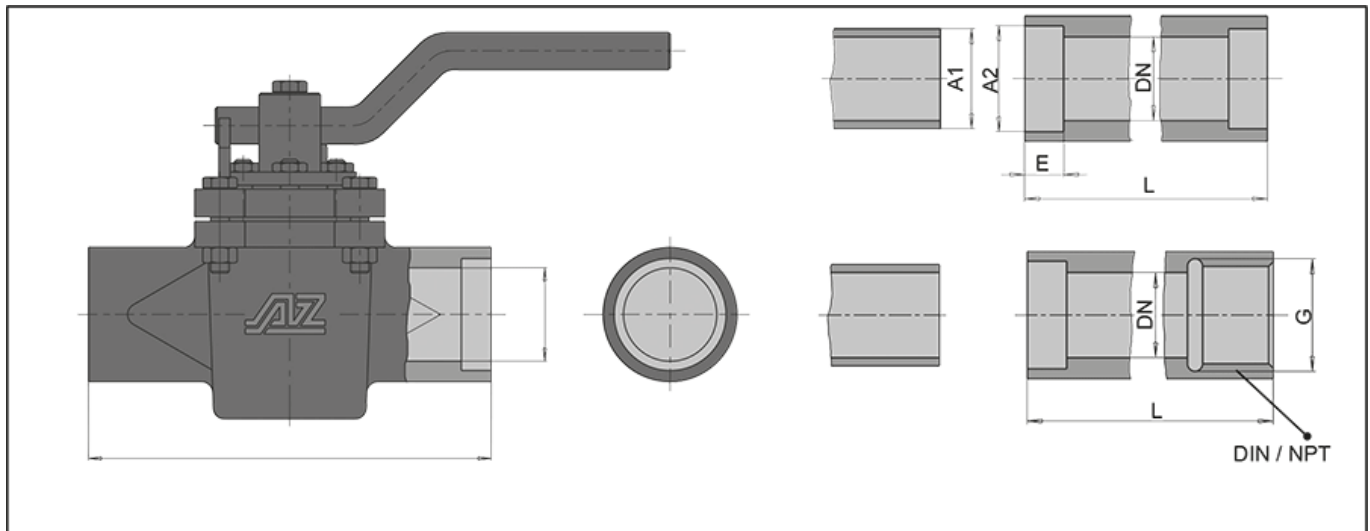

	DN		L		A1		A2		E		G
	DIN	ANSI	DIN	ANSI	mm	inch	mm	inch	mm	inch	DIN 2999
Socketwelding Ends	10	3/8"	165	130	17,1	0,675	17,25 ^{+0,25}	0,690 / 0,700	9,5	0,38	Rp3/8"
	15	1/2"	165	140	21,3	0,840	21,71 ^{+0,25}	0,855 / 0,865	9,5	0,38	Rp1/2"
	20	3/4"	165	152	26,7	1,050	27,05 ^{+0,25}	1,065 / 1,075	13	0,5	Rp3/4"
	25	1"	165	165	33,4	1,315	33,78 ^{+0,25}	1,330 / 1,340	13	0,5	Rp1"
	32	1 1/4"	180	178	42,2	1,660	42,54 ^{+0,25}	1,675 / 1,685	13	0,5	Rp1 1/4"
	40	1 1/2"	200	190	48,3	1,900	48,64 ^{+0,25}	1,915 / 1,925	13	0,5	Rp1 1/2"
	50	2"	230	216	60,3	2,375	61,11 ^{+0,25}	2,406 / 2,416	16	0,62	Rp2"
	65	2 1/2"	290	241	73,0	2,875	73,87 ^{+0,38}	2,906 / 2,921	16	0,62	-
	80	3"	310	283	88,9	3,500	89,86 ^{+0,38}	3,535 / 3,550	16	0,62	-
	100	4"	350	305	114,3	4,500	115,53 ^{+0,38}	4,545 / 4,560	20	0,75	-

Actuation

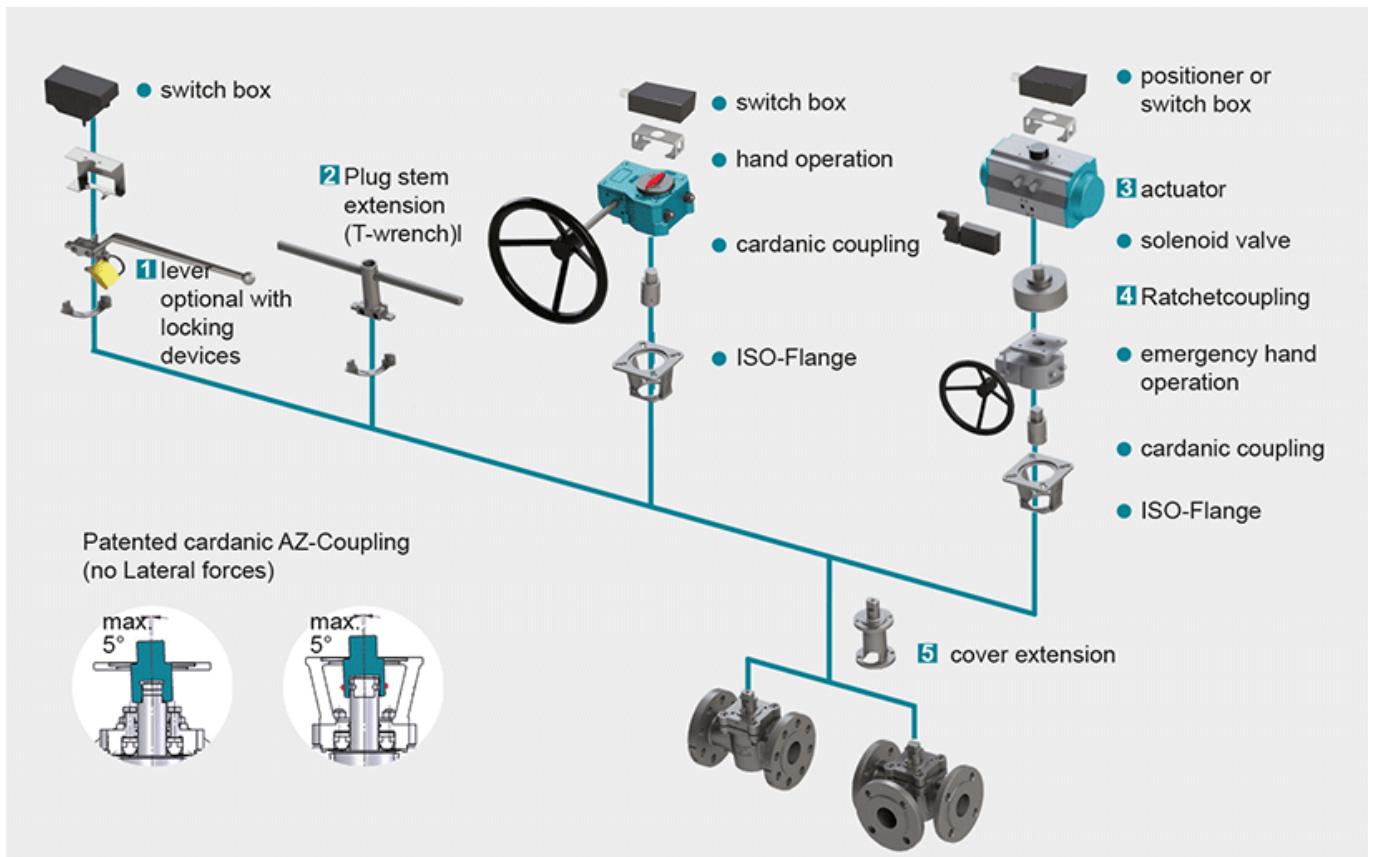

1 Locking Devices

Pilot valve combinations, pad lock eyelets, linear key conception, indexing plunger arrestor.

2 Plug stem extension

Solid construction in stainless steel with T-wrench, Standard extension 100 mm or 150 mm, non standard lengths are available on request

3 Actuators

Actuators for mounting-flange acc. to DIN ISO 5211

NEW: Pneumatic actuator AIR GEAR for plug valves with high torque =150.000 Nm

4 Ratched coupling

To usw on multiport valves with standard 90° actuator for bigger switchpositions than 90°

5 Cover extension

Solid construction in stainless steel, Standard extension 100 mm or 150 mm high, non standard lengths are available on request . Hexagonal bolts on adjustment ring freely accessible. Note: Don't use with sealing FSN/FSN-SL and CASN/CASN-SL